



LIGHTSCULPTURES

MURANO

WWW.LIGHTSCULPTURES.CO.TH

WHO WE ARE

LIGHTSCULPTURES Co., Ltd. is a lighting design Bangkok based company with glass manufacturing facilities in Murano, Venice, Italy, and China offering effective and qualitative lighting designs and lighting manufacturing functions.

LIGHTSCULPTURES, from Classic to Modern style we can provide a wide range of solutions characterised by the outstanding quality of Murano Glass, Metal finishings and State-of-the-Art technology. Besides our original designs of Chandeliers and free-flow installations we collaborate with leading architects and designers to create the desired custom solutions.

Our *Consortium* unites our design skills with the Zanchi, Vianello, Signoretto and Barbini families experience and love for extreme glass work. *"*The Bigger, Murano glass installation, the Better".**

This alliance allows the development of high quality products, customized to our client's needs. Due to the disciplined collaboration between our concept and production departments, we can offer **competitive price points*, *on time and within your budget.**

Please rest assured that we will do whatever in our power to deliver to you outstanding products well within your budget obligation.



OUR TEAM



Francesco Brancaccio
Managing Director



Francesco Cappuccio
Creative Director



Suveera Bhandhukravi
Executive Director

MANAGEMENT



Tussaporn Sangsuriyotai
Designer



Koonanan Panyahom
Designer

DESIGN TEAM



Kanya Boonrod
Office & Administration Manager



Shlatsorn Maisakuldee
Operation Manager



Suthee Bhandhukravi
Admin

OPERATION TEAM



INSTALLATION TEAM

Our installation team travels tirelessly across the Asia Pacific and the Middle East to meet the quality expectations required by our clients. They organize and lead each job autonomously or with co-operation of local contractors.

- Engineering
- Free flow constructions
- Site logistics
- Glass installation and maintenance
- Electrical systems
- Metalwork

OUR LEGACY

Commerce Minister Wanit Pananond

Head of economic diplomacy between Thailand and Japan, he was also on the National Committee for Monetary Review.

Promoter of the post-war revolution and the liberalisation of Thailand's rice and oil markets.



Plaek Pibulsonggram Prime Minister Thailand

His legacy dates back to the 1940s when he instigated the Thai cultural revolution and changed the name of Siam to Thailand (Land of the Free)

Legacy of modernisation, he laid down the laws that provided the legislative framework for the authorities that govern today's financial landscape in Thailand.



Admiral Luang Sindhu Kamolnavin

He was the Minister of Defense, the Thai Naval Supreme Commander and the Minister of Education in Thailand.



Suveera Bhandhukravi

Suthee Bhandhukravi

Members of the above families still hold prominent positions, in the Thai administration, Embassies and financial services.



AWARDS

Silver A'Design Award in "Furnitures"

Gold European Product Design Award

A'Design Award in "Arts & Crafts"

A'Design Award in "Lighting Products"

IES New South Wales Award of Commendation

Three Shortlisted Designs for OLED LIGHTING International Design Competition

First Prize in international competition "Perfect Pitch Trainer Challenge" by SKLZ

First Prize in international competition "Great Garage Door Design" by AMARR

Louis XXI (coffee table) become part of the Museum permanent collection of M.A.A.M

Bronze Prize at international competition "Kitchen gadgets of the future"

Shortlisted for the international competition "Dining in 2015"

Bronze Prize at international competition "Legno e progetto" Calligaris

Shortlisted for the international competition "Premio Vico Magistretti"

First Prize in international competition "New Puller for LAMPO"

Bronze Prize & Special Selection at Incheon international competition

Red Dot Design Award

First Prize in international competition of design "The Significant furniture 2007"

2020 (Italy)

2019 (Belgium)

2019 (Italy)

2019 (Italy)

2017 (Australia)

2013/2016 (Korea)

2011 (USA)

2011 (USA)

2010 (Italy)

2010 (Singapore)

2007 (Italy)

2007 (Italy)

2007 (Italy)

2007 (Italy)

2007 (Korea)

2007 (Singapore)

2007 (Italy)

LIGHTFESTIVALS

"The Garden of Sweeties" Light sculpture winner of Vivid Light Festival

"The Pinwheels" Light sculpture winner of Bahrain Light Festival

"The Sunflowers" Light sculpture winner of Vivid Light Festival/Guangzhou Festival

"Framed" Light sculpture finalist at Amsterdam Light Festival

"David" Light sculpture shortlisted at Bella Skyway Festival

2018 (Sidney)

2017 (Bahrain)

2017 (Sidney)

2017 (Amsterdam)

2017 (Torun)



red dot design award
winner 2007



A'DESIGN AWARD
WINNER 2020
SILVER

2019 GOLD WINNER
EUROPEAN
PRODUCT
DESIGN
AWARD

Amarr



FONDAZIONE ALDO MORELATO
Osservatorio sull'arte applicata nel mobile

calligaris

ARCHITECTS NETWORK

Australia

Destination NSW

Studioaria

China

Wyndham Hotel Group

Hongkong & Macau

Buz Design

LRF Designers

Malaysia

Blue Water Studio

KL Pavilion Design Studio

Singapore

BD Design

Lightbox

JPA Design

Wilson Associates

Thailand

APLD

ASC

PIA

JKY Concept

KGTU

Leo International Design

Onyx

P49

UAE

Kristina Zanic

Shapoorji Pallonji

STC Oman

UK

AlexKravetzDesign

Artlink

Wilson Associates

Vietnam

Areco Realty

Group 8 Asia

Noor

PROJECT PORTFOLIO

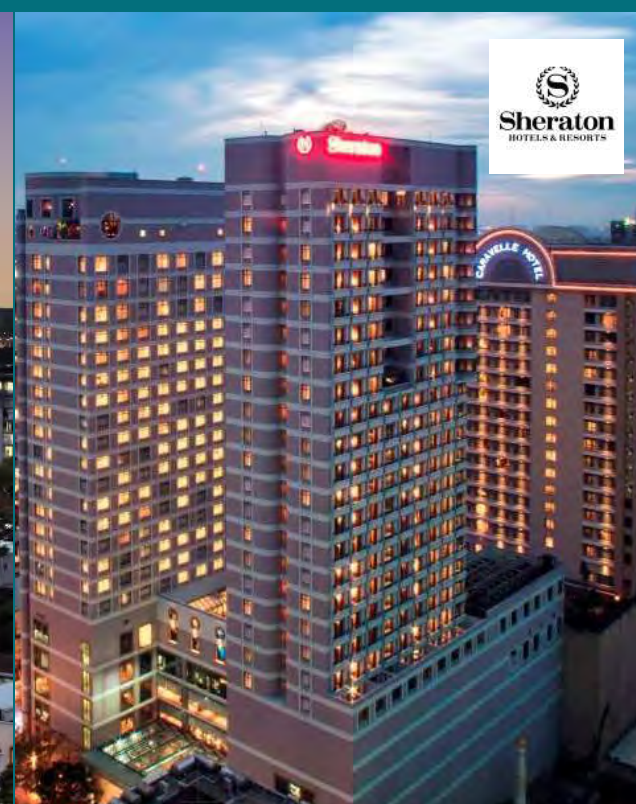
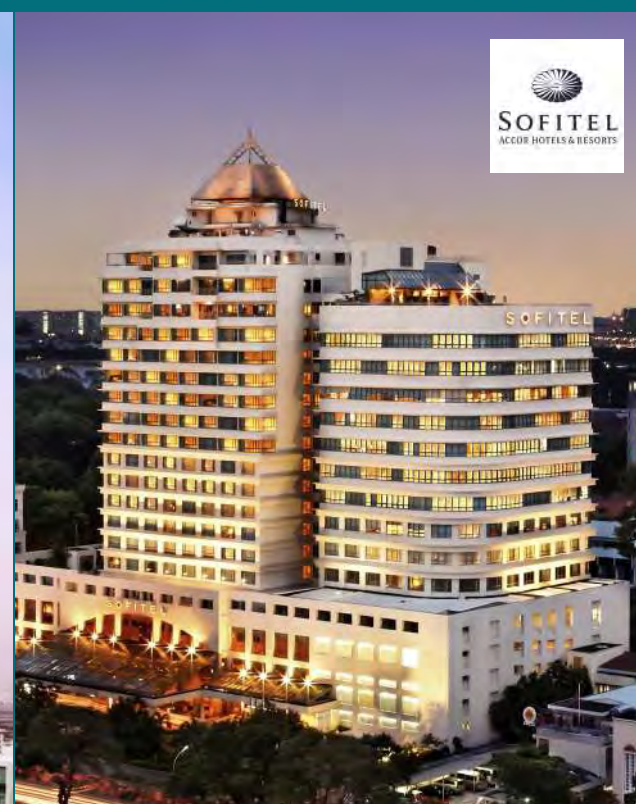
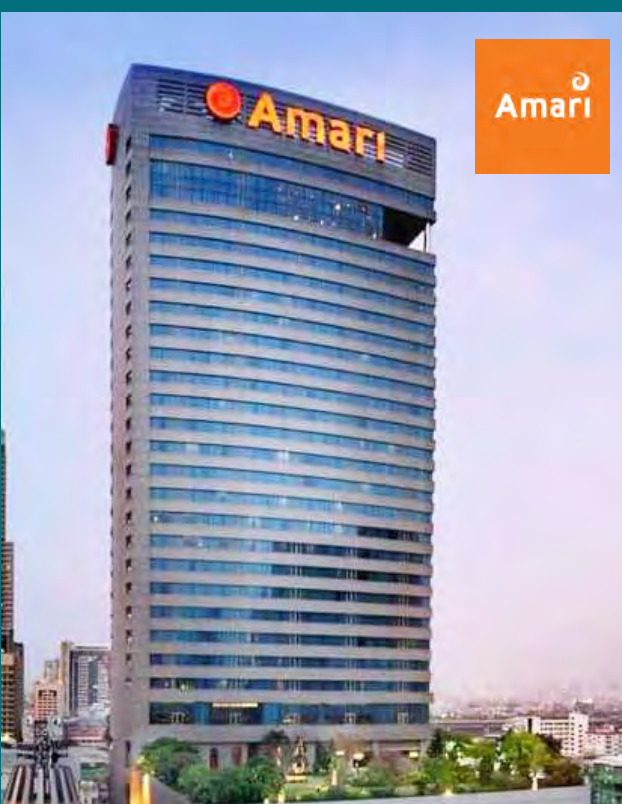

LIGHTSCULPTURES

HOTELS NETWORK

Amara

Shanghai

Amari

Bangkok

Pattaya

Banyan tree

Kuala Lumpur

Hilton

Cape Sierra

Da Nang

Hangzhou

Oman

Mai House

Saigon

Novotel

Phuket

Pavilion

Kuala Lumpur

Rembrandt

Bangkok

Shama

Bangkok

Sheraton

Kuching

Saigon

Sofitel

Saigon

Stonehill

Bangkok

Wingate

Sanya

Wyndham

Tai an

RESTAURANT NETWORK

Hongkong

Dragon Feast sheung shui

Dragon Gown

Dragon King Hopewell Center

Dragon King Whampoa Garden

Dragon King WTC

Dragon Seal ICC Tower

Shanghai

Dragon King

Imperial Seal

Taipei

Breeze

VILLA NETWORK

Villa Peera

Bangkok 2000 sqm.

Villa Tapesa

Delhi 4000 sqm.

Villa Su

London 4000 sqm.

COMMERCIAL NETWORK

Bumrungrad International Hospital - Thailand

Chiang Saen Port - Thailand

Pavilion Elite Mall - KL

Pavilion Damansara Heights - KL

LIGHTSCULPTURES



ARS Murano was founded in 1982 by Roberto Cammozzo, Elio Raffaelli and Renzo Vianello. The three partners have different backgrounds but they all previously collaborated with the famous artist Livio Seguso, whose influence proved fundamental in their training.

In his furnace, they learned to develop precision, love for detail, purity, elegance and a deep understanding of glass. Ars was created on these same principles, with Renzo, Roberto and Elio integrating their great expertise with a large passion for their art and the natural desire to express it.

Every design speaks a different language and it is only through his devotion, humility and intimate knowledge of the substance, now liquid and incandescent, now hard and cold, that the glass-maker can respect its original features, thus preserving the personality of both the inventor and the creator.





BUTTERFLY MAKING



LIGHTSCULPTURES



**CRUISE SHIP
TOQUE**



LIGHTSCULPTURES



CRUISE SHIP
TOQUE MAKING



LIGHTSCULPTURES

Horses by Hussein



LIGHTSCULPTURES
MURANO



ZANCHI

Lightsculptures partner Fabiano Zanchi is a Master Glass Blower, the soul of Zanchi Italy.

He started his apprenticeship in Murano at the ages of 14 years old and has been working since then. He moved to China in 2014 and started producing beautiful chandeliers for renown Chinese and international brands.

He returned to Italy in 2018. Our chandelier has been recently chosen by Lissoni Associati Milano to complement the Swire Hotel Shanghai.



SLEEPER

GLOBAL HOTEL DESIGN

SEPTEMBER | OCTOBER 2018

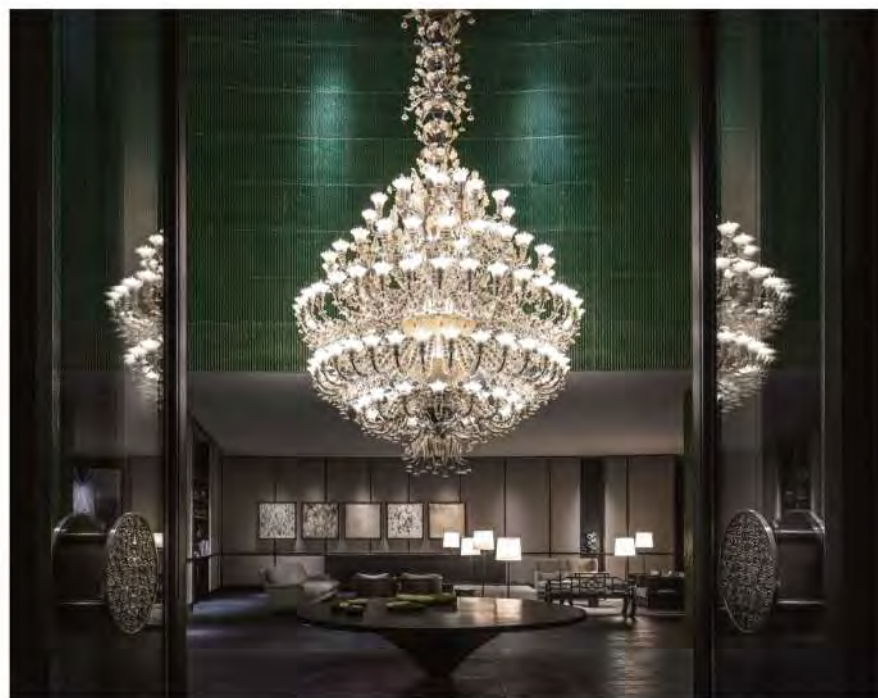

The Middle House
Swire's House Collective lands in Shanghai with an east-meets-west scheme by Piero Lissoni

Priya Paul
The leading lady of India's boutique hotel sector talks form, function and having fun

Bikini Island & Mountain Hotel
The team behind 25hours Hotels set their sights on reinventing the leisure sector



LOCATION REPORT

The Middle House SHANGHAI

Featuring a dramatic design scheme by Piero Lissoni, the fourth property in Swire's House Collective lands in China's most cosmopolitan city.

Words: Li Mu | Photography: © Edmon Leong

Shanghai's current hotel boom continued this spring with the opening of Piero Lissoni's The Middle House. The two towers it occupies form part of a Swire co-owned development that includes office blocks, a shopping mall, the world's largest Starbucks and the city's new Sukhothai hotel. Wong & Ouyang Architects designed the masterplan and footprint of the whole complex, while Lissoni Associati was in full charge of the hotel's design; there was no competition – Swire commissioning on the strength of his studio's previous hotel work.

The entrance journey for the hotel is signposted by bamboo planting and two walls of green bamboo-motif tiles along the driveway in front of the building. The hotel's exterior façade features a series of rounded aluminium louvres, which provide shade and privacy while creating a textured aesthetic that visually distinguishes it from surrounding developments. Looking up at them, the two towers are a little foreboding, clad in dark grey aluminium, a colour that Lissoni remembered from past visits to China and the roof tiles used on old buildings.

Guests arrive at the hotel's glass box entrance that leads into a green-tiled room dominated by a six-metre-high, 3,760-piece chandelier created by Fabiano Zanchi. The effect is dictionary-defining 'dramatic'.

"I'm interested in connecting east and west and there are two different worlds at play here in this green room," Lissoni explains. "You have the special ceramics on the wall made in China, and then there is this Murano glass chandelier made in Venice. I wanted to represent the honourable connection between west and east, between Venice and China, between glass and ceramics and in a romantic way, Marco Polo was very much in my mind."

From here, the L-shaped lobby and reception area opens up, decorated in muted tones with an informal collection of large homely sofas, tables and lights, which in design terms allude to the hotel's tagline of 'Our House, Your Home'.

Lissoni took inspiration from the city's rich heritage of craftsmanship and culture, marrying his minimalist style with classical Shanghaiese elements. The majority of furniture has been

125

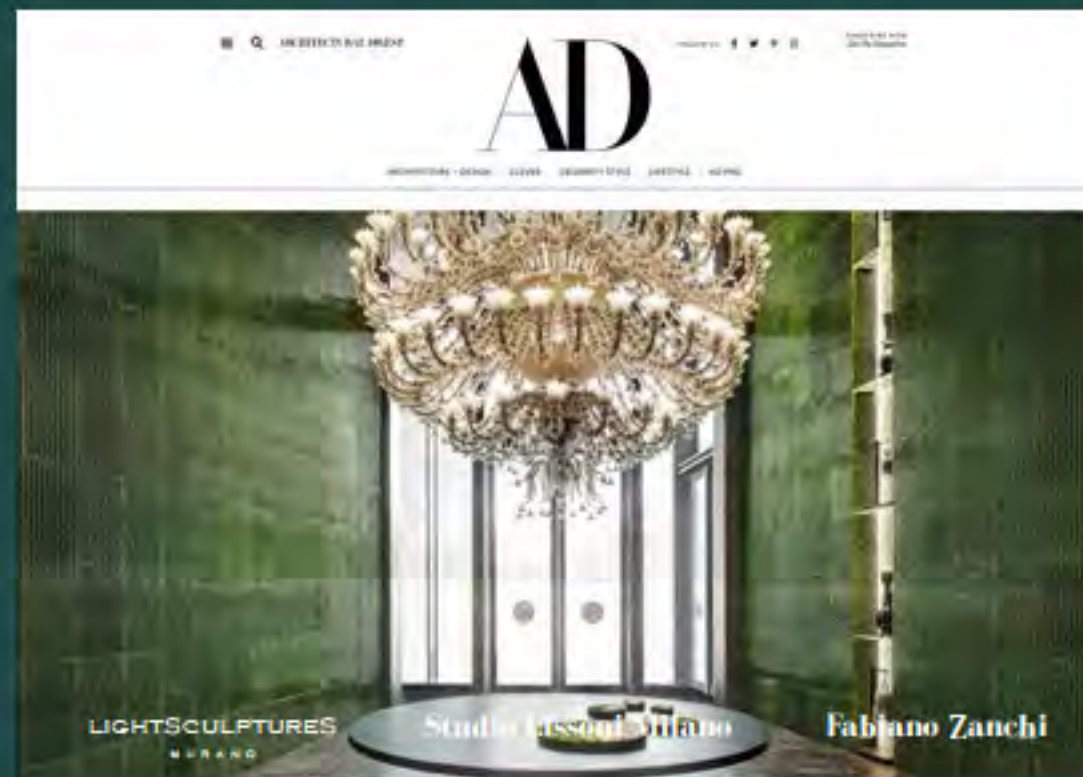

Website Publication

www.architecturaldigest.com/story/shanghai-design-travel-guide

www.sleepermagazine.com/review-the-middle-house/

www.elledecor.com/it/architettura/a24256476/tre-studi-di-architettura-italiani-in-cina/

<https://hoteldesigns.net/industry-news/swire-hotels-announces-official-opening-of-the-middle-house-in-shanghai/>

LIGHTSCULPTURES
MURANO



Swire Hotel Shanghai by Lissoni

ZANCHI

PROJECTS

With a wide range of experience in the hospitality sector, our design team works tirelessly with leading interior design firms and 5 stars hotels around the world.





Amari

AMARI WATERGATE BANGKOK

for APLD Lighting and JKY

GEMS CLOUD

LIGHTSCULPTURES

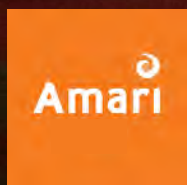

AMARI WATERGATE BANGKOK

for APLD Lighting and JKY

GEMS CLOUD

LIGHTSCULPTURES



AMARI WATERGATE BANGKOK

for APLD Lighting and JKY

GEMS INSTALLATION

LIGHTSCULPTURES

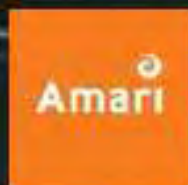

AMARI PATTAYA
for APLD Lighting and Steven Leach
FLUID GLASS

LIGHTSCULPTURES



SHAMA ASOKE

for ASC Interior

THREE DIMENSIONAL WAVE

LIGHTSCULPTURES



SHAMA ASOKE

for ASC Interior

TWO DIMENSIONAL WAVE

LIGHTSCULPTURES

PAVILION HOTEL

PAVILION

PAVILION BY BANYAN TREE

for KLPDS

CURVE GEMS

LIGHTSCULPTURES

PAVILION

PAVILION BY BANYAN TREE
for KLPDS
CURVE GEMS

LIGHTSCULPTURES



PAVILION

PAVILION BY BANYAN TREE

for KLPDS

CURVE GEMS

LIGHTSCULPTURES



PAVILION BY BANYAN TREE

for KLPDS

CURVE GEMS INSTALLATION

LIGHTSCULPTURES

PAVILION

PAVILION BY BANYAN TREE

for KLPDS

LOBBY ONE

LIGHTSCULPTURES



PAVILION

PAVILION BY BANYAN TREE

for KLPDS

LOBBY ONE

LIGHTSCULPTURES



PAVILION

PAVILION BY BANYAN TREE

for KLPDS

LOBBY EIGHT

LIGHTSCULPTURES

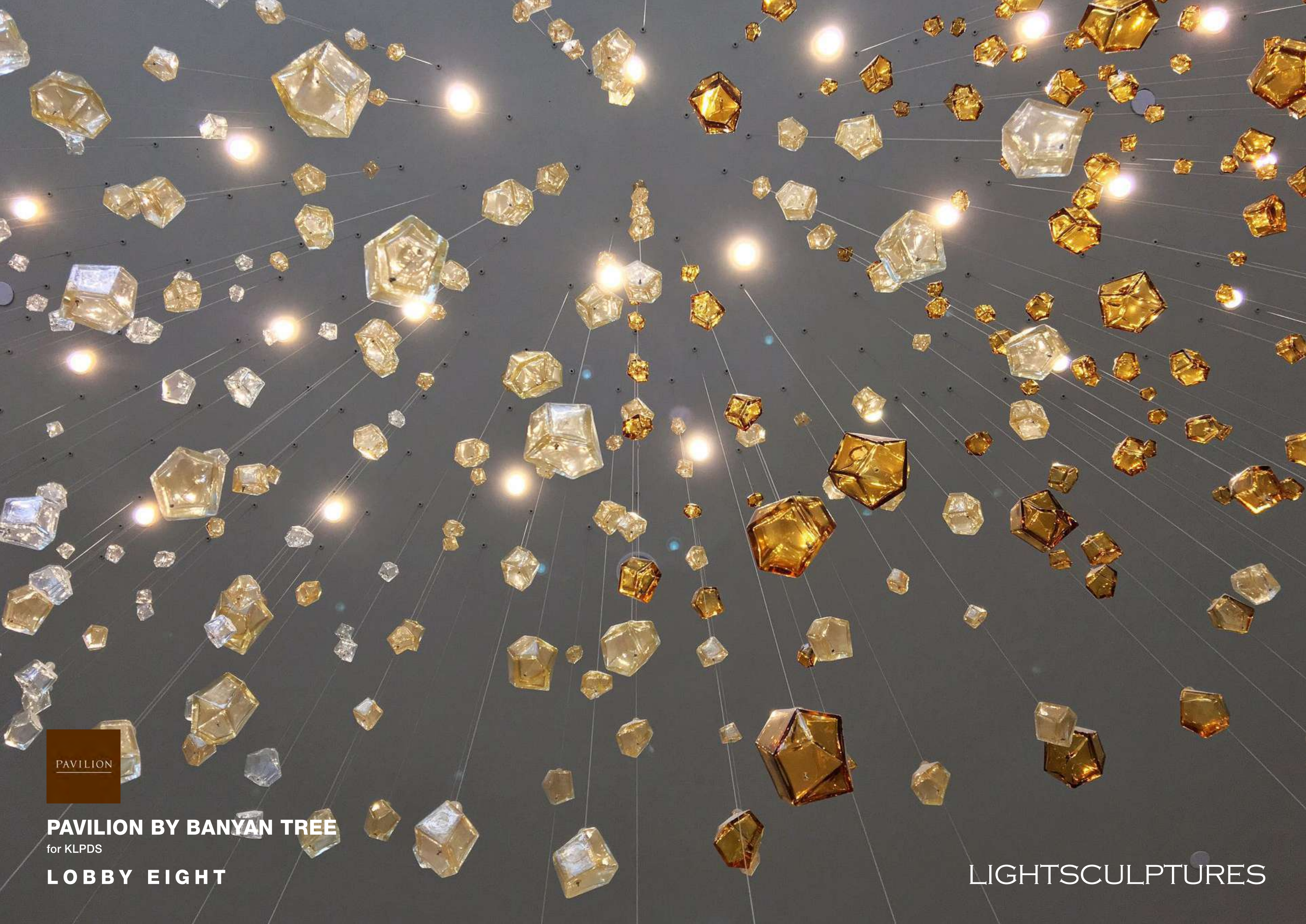

PAVILION

PAVILION BY BANYAN TREE

for KLPDS

LOBBY EIGHT

LIGHTSCULPTURES



PAVILION

PAVILION BY BANYAN TREE
for KLPDS
BALLROOM

LIGHTSCULPTURES



PAVILION

PAVILION BY BANYAN TREE

for KLPDS

BALLROOM

LIGHTSCULPTURES



PAVILION

PAVILION BY BANYAN TREE
for KLPDS
ALLDAY DINING

LIGHTSCULPTURES



PAVILION

PAVILION BY BANYAN TREE

for KLPDS

GRAND FUNCTION

LIGHTSCULPTURES



PAVILION

PAVILION BY BANYAN TREE

for KLPDS

VIP DINING

LIGHTSCULPTURES



BANYAN TREE KUALA LUMPUR

for KLPDS and Studio Aria

LANTERNS INSTALLATION



LIGHTSCULPTURES



BANYAN TREE KUALA LUMPUR
for KLPDS and Studio Aria
LANTERNS

LIGHTSCULPTURES

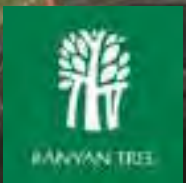

BANYAN TREE KUALA LUMPUR

for KLPDS and Studio Aria

LANTERNS L53

LIGHTSCULPTURES

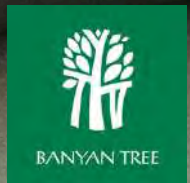

BANYAN TREE KUALA LUMPUR

for KLPDS and Studio Aria

GUESTROOMS



LIGHTSCULPTURES



WINGATE SANYA

for Wyndham Shanghai

SEAWEED

LIGHTSCULPTURES

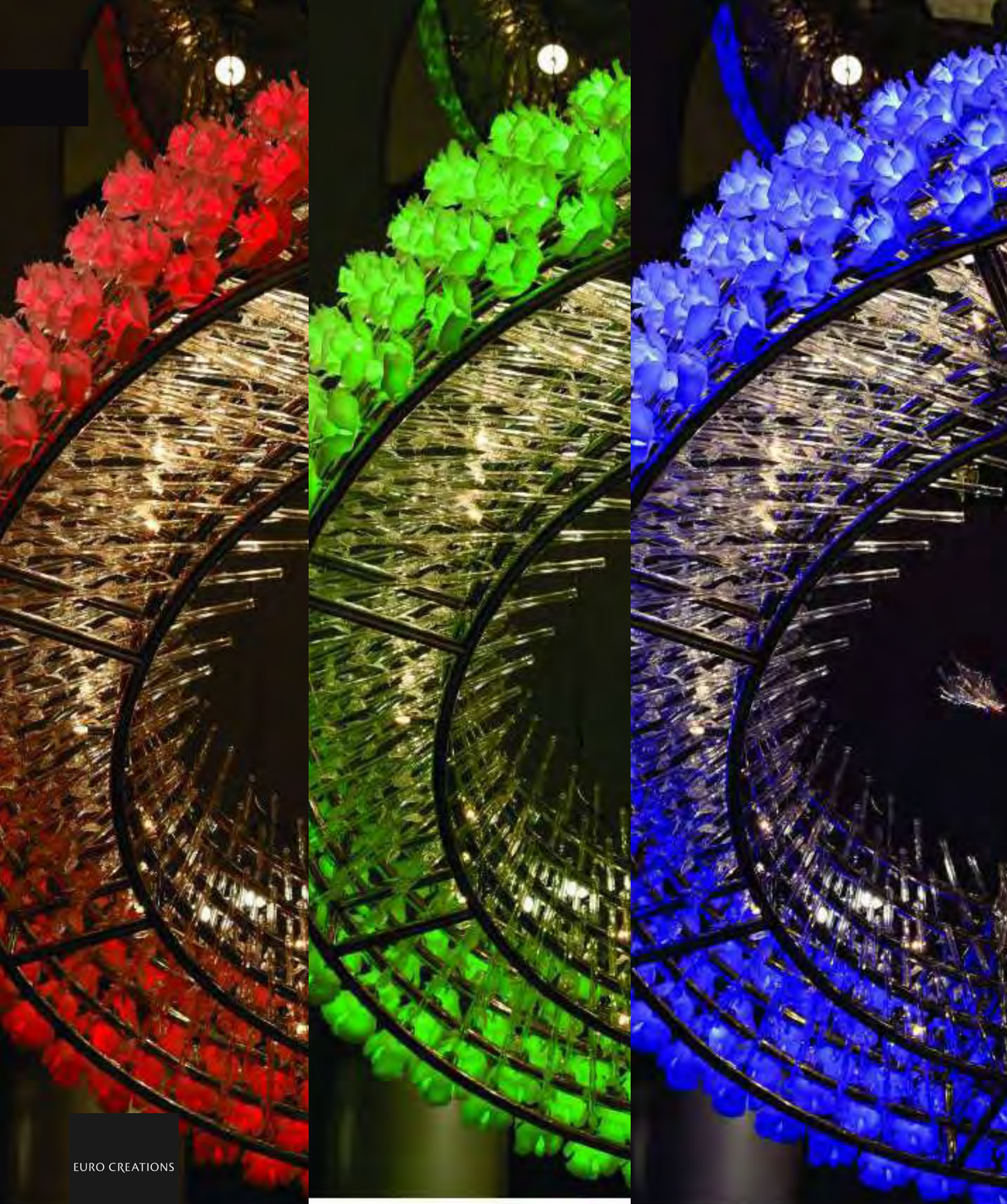

EURO CREATIONS

EURO CREATIONS BANGKOK BOUQUET





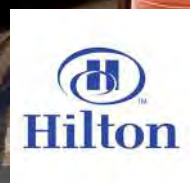

HILTON DA NANG

for NOOR Design

PICCOLI

LIGHTSCULPTURES

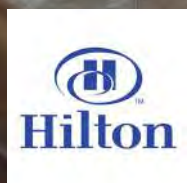

HILTON DA NANG

for NOOR Design

PICCOLI



HILTON DA NANG

for NOOR Design

LANTERN



LIGHTSCULPTURES

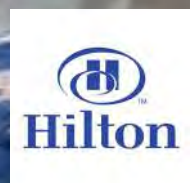

HILTON DA NANG

for NOOR Design

LOTUS

LIGHT SCULPTURES



HILTON DA NANG

for NOOR Design

PRESIDENTIAL SUITE

LIGHTSCULPTURES



HILTON OMAN

for Alex Kravetz Design

TITAN

LIGHTSCULPTURES



NOVOTEL PHUKET

for LEO Design Studio and JKY

BAR SWARM

LIGHTSCULPTURES

TURBILLON for NOOR DESIGN

SOFITEL SAIGON



SOFITEL SAIGON

for NOOR DESIGN

LEAF

LIGHTSCULPTURES

LIGHTSCULPTURES



SOFITEL SAIGON

for NOOR DESIGN

LEAF



LIGHTSCULPTURES



MAI HOUSE SAIGON
for TBS Group
ATRIUM



LIGHTSCULPTURES



MAI HOUSE SAIGON
for TBS Group
ATRIUM



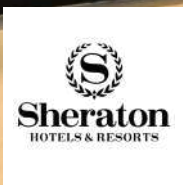

SHERATON SAIGON

for NOOR DESIGN

SEEDS

LIGHTSCULPTURES



龍齋

DRAGON SEAL
RESTAURANT & BAR

龍齋



ICC TOWER HONGKONG
FRONT DOOR

LIGHTSCULPTURES



**ICC TOWER HONGKONG
HALLWAY**



LIGHTSCULPTURES



AMARA SHANGHAI

for JPA Design

GENESIS

LIGHTSCULPTURES



AMARA SHANGHAI
for JPA Design
GENESIS

LIGHTSCULPTURES

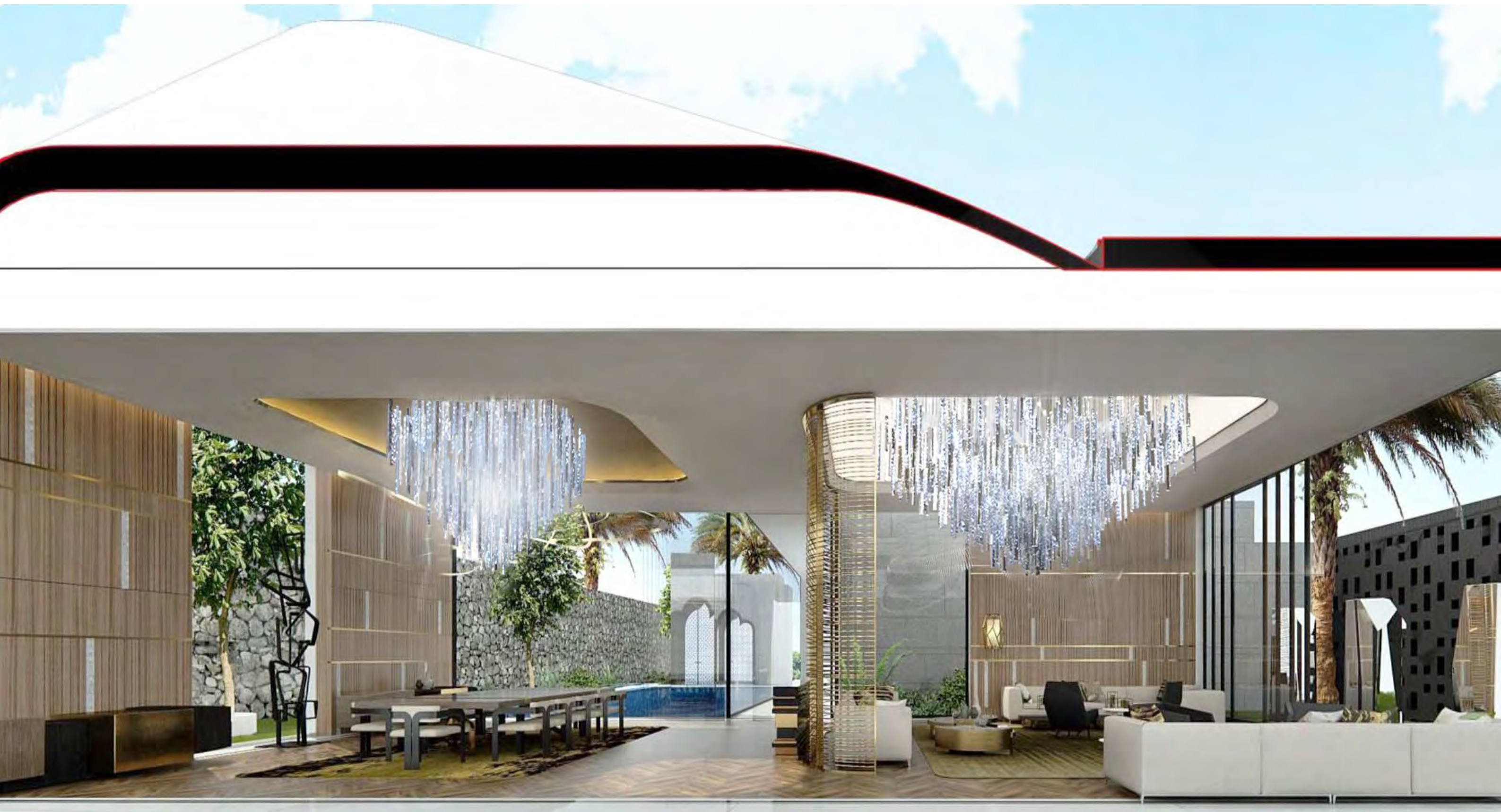

VILLA TAPESH
for ARRC

LIGHTSCULPTURES



VILLA TAPESH
for APRCO

LIGHTSCULPTURES

Living Space - for ARRCC

VILLA
TAPESH



VILLA TAPESH
for ARRCC

LIGHTSCULPTURES

LIGHTSCULPTURES



Illusion

2016 - glass, bronze & light

VAL

Lobby chandelier

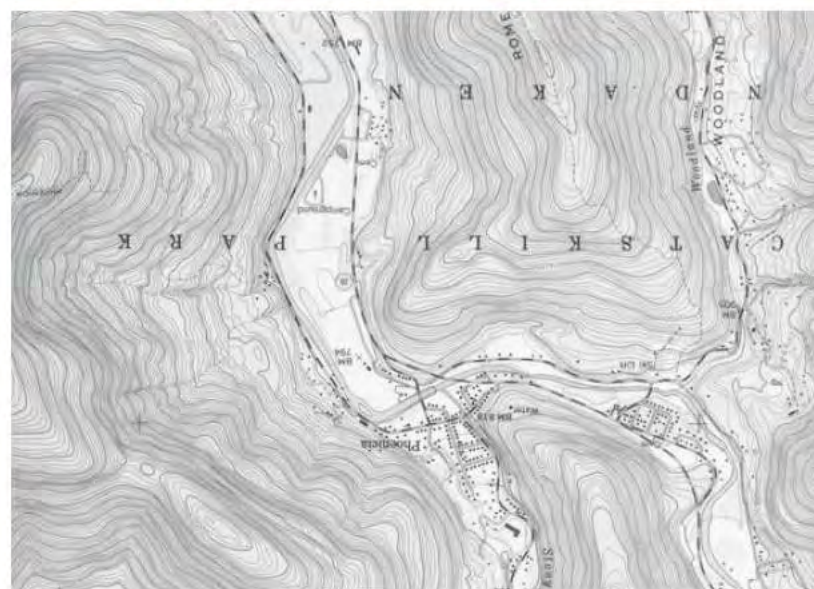

Lobby chandelier

concept 1-1 “Ice Crystal”

Known for its distinctively delicate feature and the saying "no two snowflakes are ever alike", the concept of the chandelier is designed to showcase the intricate and utterly unique ice crystals in frosty Murano glass evoking the Alps peaks.



Lobby chandelier
concept 1-2

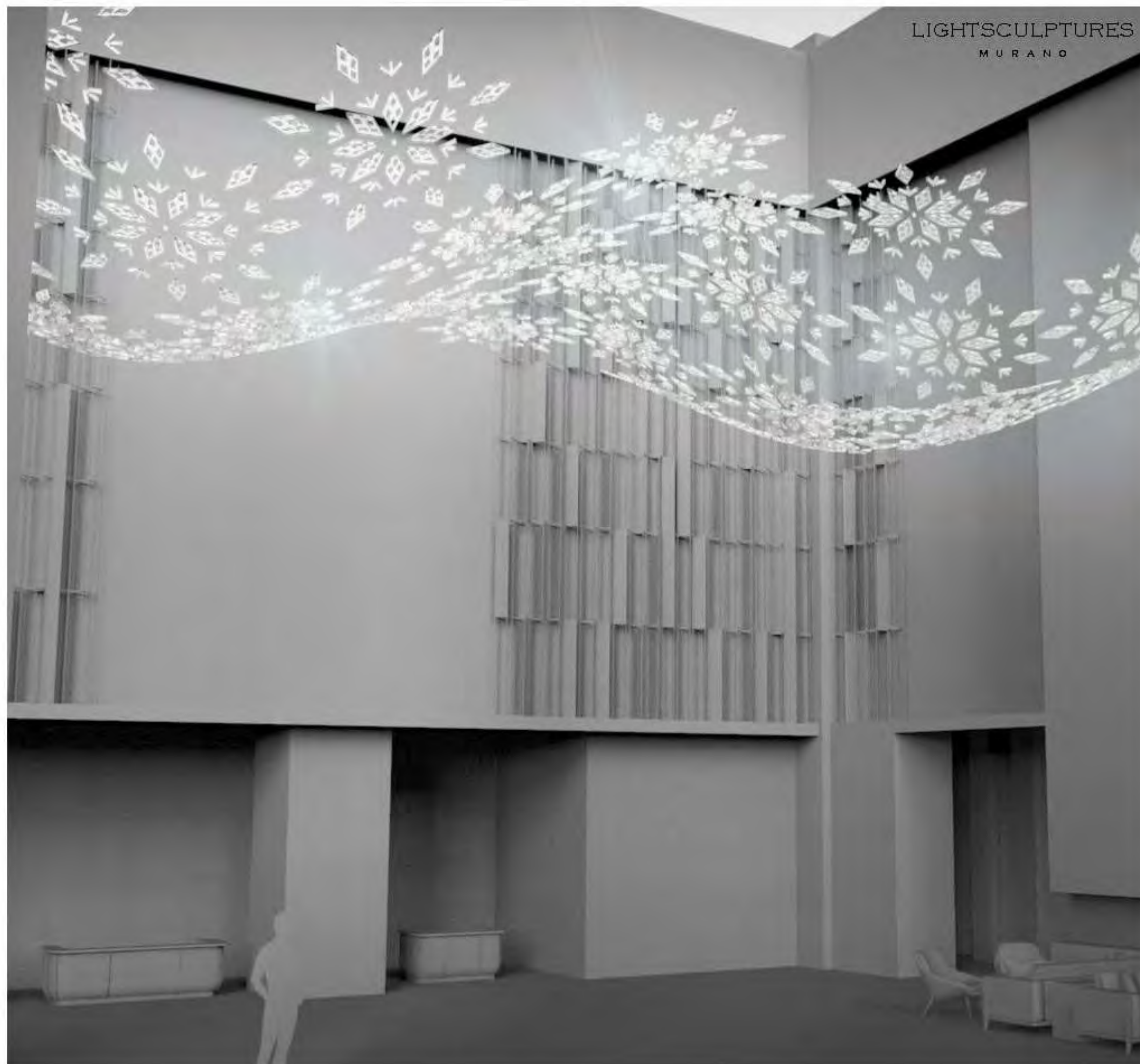

Lobby chandelier
concept 2-1



Lobby chandelier

concept 2-2 “Sunrise”

The sculptural chandelier aim to capture the refraction of the sun ray across a frozen waterfall as view from behind. A snapshot of the iridescent ray of the sun.

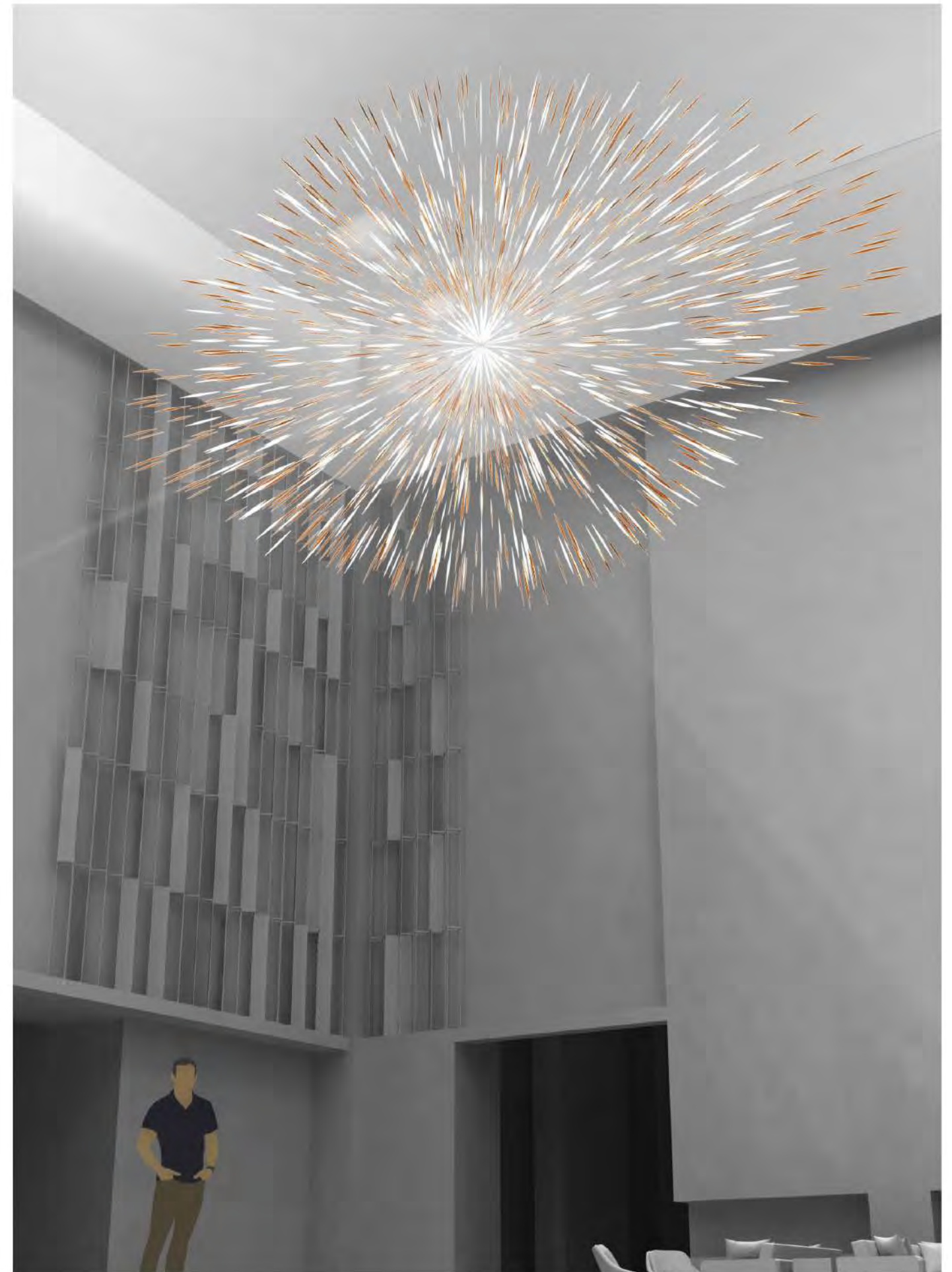
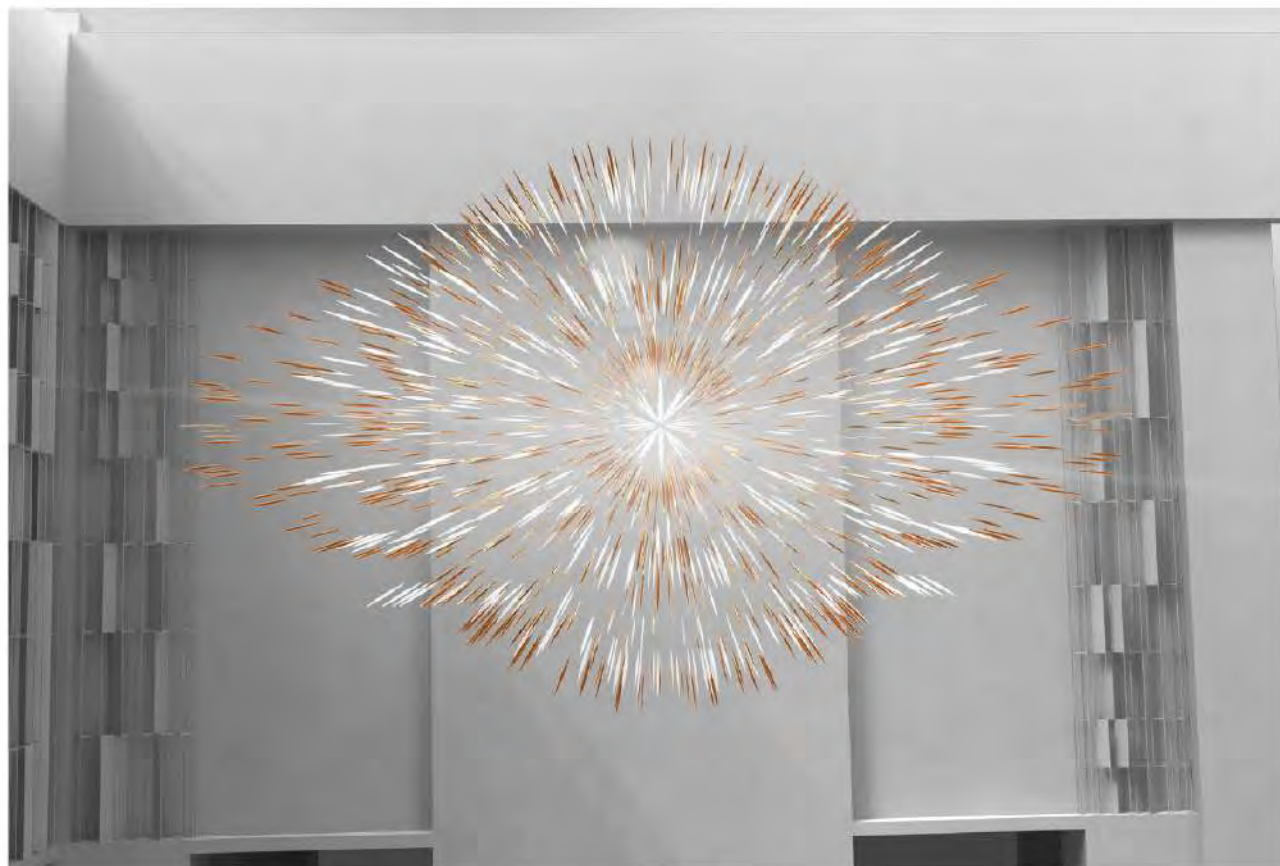

Lobby chandelier

concept 3 “Geodesic”

Inspired by the ridges of the mountain and a free flowing snowboard attacking the most extreme of slopes in synchrony with Mother Nature, the dramatic sculpture disperse the glass components in a free flow element.

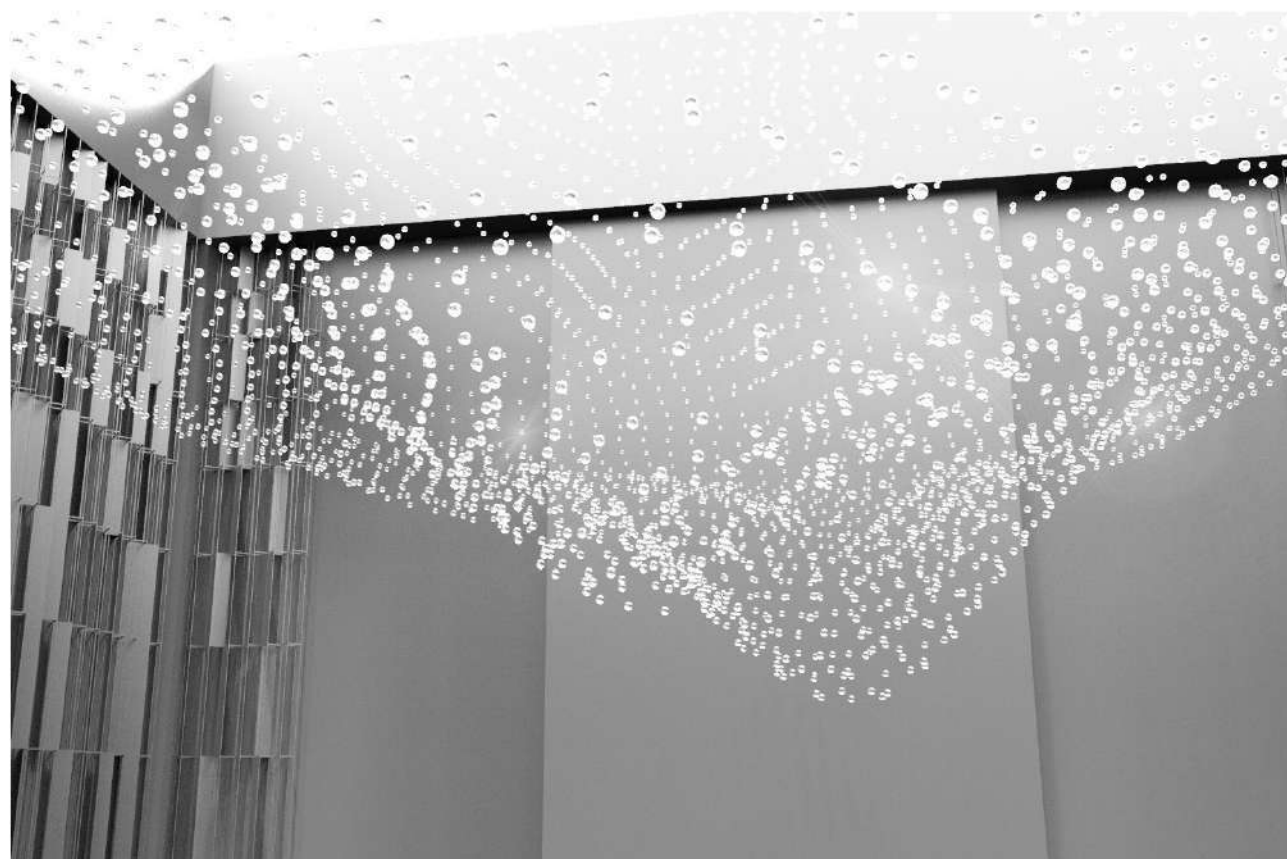

Suite staircase chandelier

“Ice Stalactites”

Situated at the staircase, the free flow jagged Murano glass components draw its inspiration from the ice stalactites found in caverns and caves in remote winter land.







Rembrandt

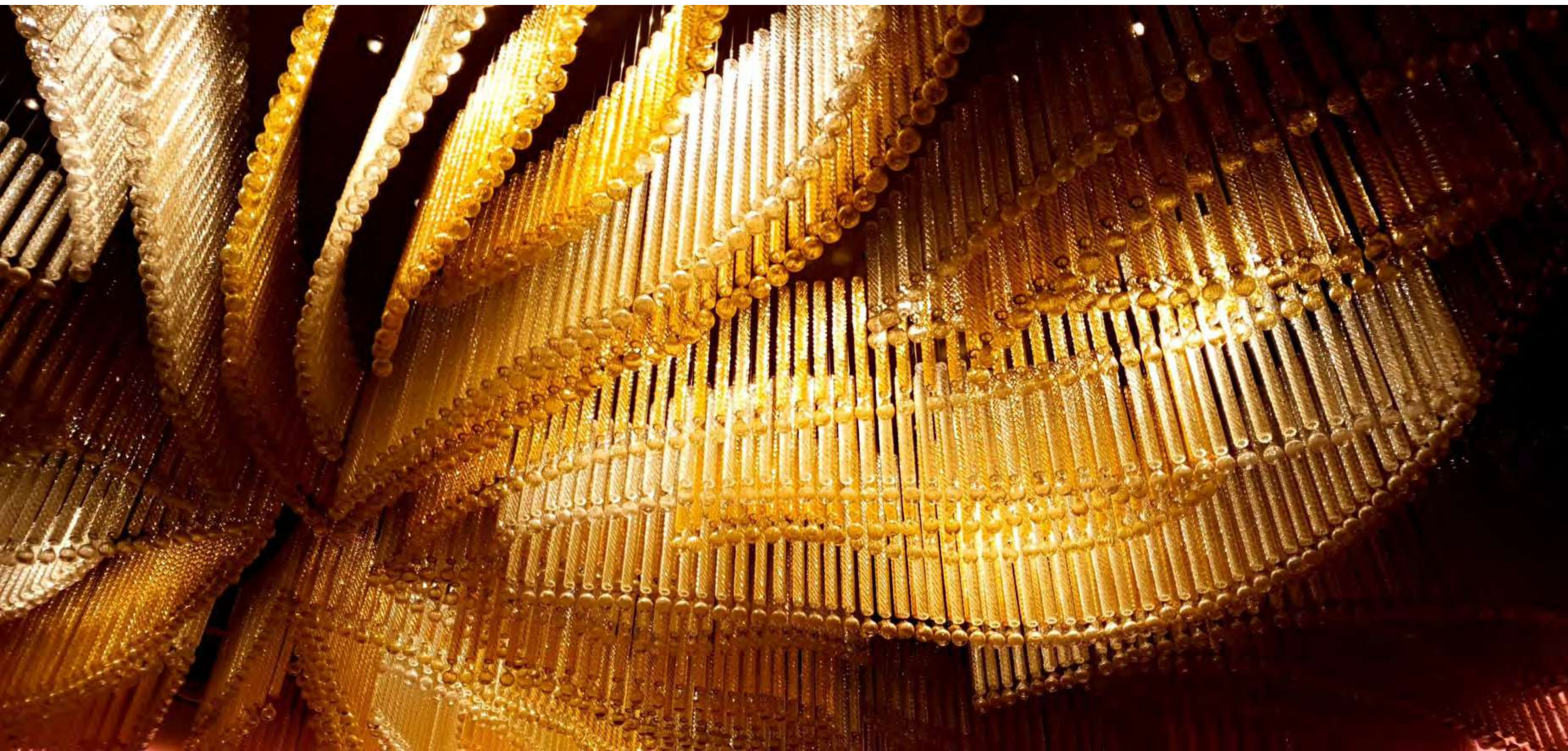

Rembrandt



Framed



Framed

We are trusted by





THANK YOU

WWW.LIGHTSCULPTURES.CO.TH

SATISFIED CUSTOMER

PAVILION BY BANYAN TREE OPENING DAY

21 DECEMBER 2018